

PANEL MOUNTING

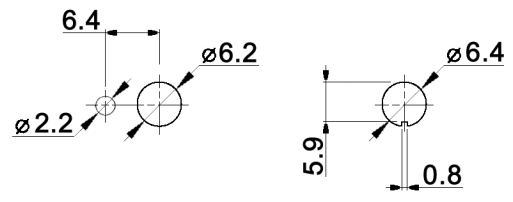

CONTACT ARRANGEMENT

code for x	function	connected terminals
D	ON - ON	1-2 alternating with 2-3
F	ON - MOM	rest position: 1-2; pushed down: 2-3

Specifications:

- Contact rating: 3A, 250V AC / 6A, 125V AC  
4A, 30V DC / 5A, 12V DC  
6A, 6V DC
- Contact resistance: 20mOhm max.
- Insulation resistance: 1 000MOhm min. at 500V DC
- Dielectric strength: 1 500V, 50Hz for the duration of 1 minute
- Operating temperature: -45°C to +140°C
- Mechanical life: 30 000 cycles
- Soldering conditions: hand-soldering: max.: 420°C, 3sec., 60W  
auto-soldering: max.: 270°C, 5sec.
- Mounting instruction: max. torque: 49Ncm
- Material: Terminal: brass, C1020 silver plated  
Case: DAP  
Housing: stainless steel, CNS9265  
Bushing: copper alloy, C3604BD nickel plated  
Actuator: copper alloy, C3604BD chrome plated
- Included accessories: 2 pcs. nut M6x0.75, nickel plated, 9mm wrench size  
1 pc. tooth washer  
1 pc. locking washer

Compliance: RohS II (2011/65/EU)

Tolerances: 0.00: ±0.25mm 0.0: ±0.40mm		Date	Name	<h1>MPA 106 x</h1>
		08/09	dr	
Contact arrangement	07/15	dr	<b>knitter-switch</b>	<h1>30 19 01</h1>
Dimension	01/11	dr		
Panel mounting	05/10	dr		
Modifications	Date	Name		Page 1/1